

TKN 2 TERRACES

Lifeline comforts for lifestyle living...

Salhunse, Opp to Brigade Meadows, Kanakapura Main Road



Homes that match your
Luxury life style
LIFE STYLE VILLAS

Marketed by



BLUEPEAK VENTURES
988 988 1876
www.bluepeak.blue



EAST FACING VILLAS

Typical Land are (Exclusive use)

30X40 sft - 1200 sft

Total : area Villa

(Including Decks and Terraces) - 2930 sft



NORTH FACING VILLAS

Typical Land are (Exclusive use)

30X50 sft - 1500 sft

Total : area Villa

(Including Decks and Terraces) - 3450 sft



WEST FACING VILLAS

Typical Land are (Exclusive use)

30X40 sft - 1200 sft

Total : area Villa

(Including Decks and Terraces) - 2930 sft



GROUND FLOOR PLAN



FIRST FLOOR PLAN



SECOND FLOOR PLAN



GROUND FLOOR PLAN



FIRST FLOOR PLAN

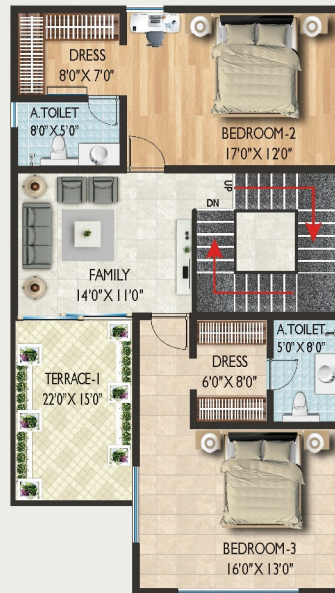

SECOND FLOOR PLAN



GROUND FLOOR PLAN



FIRST FLOOR PLAN



SECOND FLOOR PLAN



Amenities



Street Lights



CCTV Surveillance



24 Hrs Security



24 Hrs Water Supply



UPS Provision
for Each Villa

How to Reach Our Project

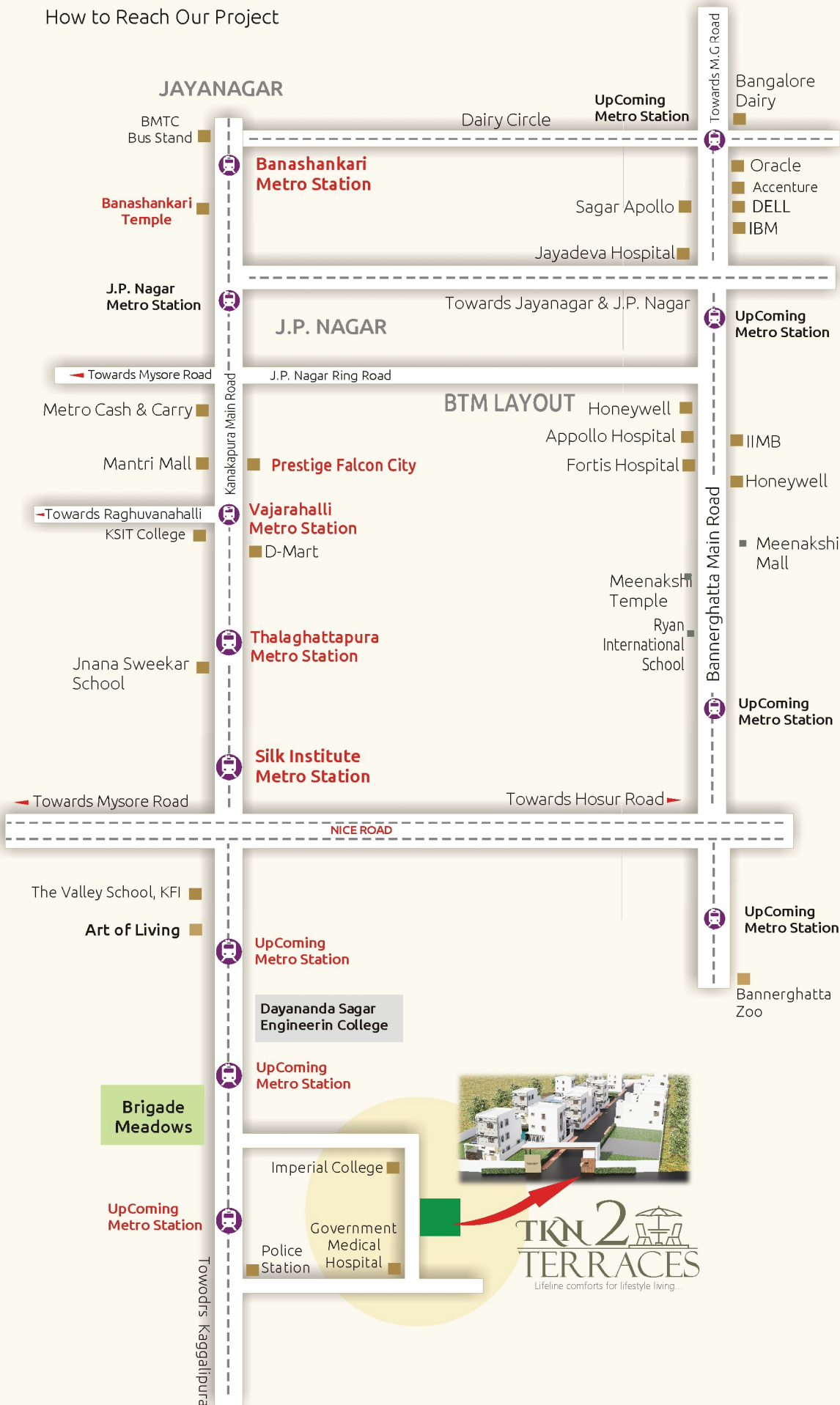

NEAR BY EDUCATIONAL INSTITUTIONS :

- Kumarans-CBSC
- Delhi Public School
- Alpine Public School-CBSC
- Yellamma Dasappa Technical Institute
- Yashasvi International School-ICSC
- KSIT Engineering College
- RMS School • Deeksha College
- City Engineering College
- Jyothi Kendria Vidayala
- Dr. Chandramma Dayananda Sagar Institute of Medical Education and Research
- Dayananda Sagar Engineering College

NEAR BY HOSPITALS :

- Sai Ram Hospital
- Siddalingappa Memorial Hospital
- Mathru Shree Hospital
- Shankar Hospital • BGS Hospital
- Sri Sri Ayurveda Hospital

NEAR BY Shopping Centers :

- D-Mart • Metro Cash & Carry
- Mantri Mall • Forum Mall
- Brand Factory
- Gopalan Arcade • Reliance Fresh
- Smart Super Mart

NEAR BY YOGA MEDITATION CENTRE :

- Art of living
- Pyramid Velly
- Sahaj Marg Spirituality Foundation

